

VAN STAAL

**VAN STAAL
VS20LSX2
COMPONENT DIAGRAM**

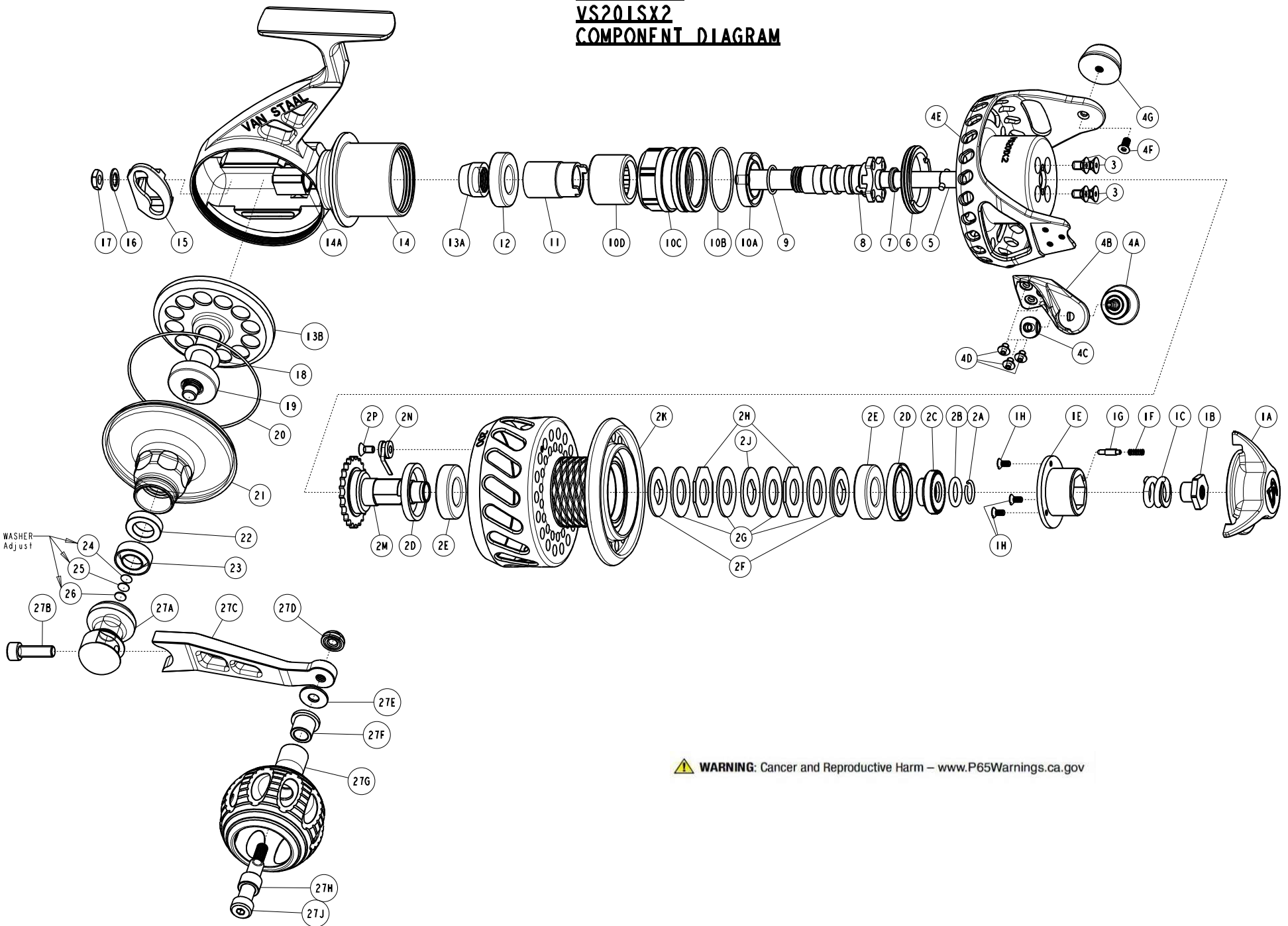

WARNING: Cancer and Reproductive Harm – www.P65Warnings.ca.gov

Van Staal VS201SX2 Part List

Key No.	Description	Part No.		Q'TY	Key No.	Description	Part No.		Q'TY
		SAP#	VS201SX2				SAP#	VS201SX2	
1	Drag Knob Assembly (Kit)	1535472	VBQ332-10	1	9	Spool Shaft Guide O-Ring	1534517	ORR19	1
1A	Drag Knob	1601327	VBQ032-10	1	10	Clutch Housing Assembly	1564571	VSG4038-02	1
1B	Drag Nut	1534954	VBQ066-01	1	10A	Clutch Housing Cup Seal	1534526	OSPR1	1
1C	Drag Spring	1534950	VBQ043-01	1	10B	Clutch Housing O-Ring	1538501	ORR21	1
1D	Drag Knob Washer		N/A	1	10C	Clutch Housing	1605973	(VSG038-02)	1
1E	Drag Knob Cap	1534956	VBQ071-01	1	10D	One Way Clutch	1535194	(VSB2090)	1
1F	Drag Click Spring	1534550	SH049-01	1	11	One Way Clutch Sleeve	1535190	VSB2014	1
1G	Drag Click Pawl	1534964	VBQ149-01	1	12	Ball Bearing	1534401	BGRS3-B	1
1H	Drag Knob Cap Screw	1534506	HX107-04	3	13	Gear Kit	1564572	VSG4312-02	1
2	Spool Assembly (Kit)	1564557	VSG321-02	1	13A	Pinion Gear		(SR2011L)	1
2A	Retainer Ring	1534872	SR3041	1	13B	Main Gear Assembly		(VSG312-02)	1
2B	Spool Retainer O-Ring	1534519	ORR3	1	14	Body Assembly	1564582	VSJ301-02	1
2C	Spool Retainer	1535191	VSB2024-B	1	14A	Body Bushing	1534752	SR2077-02	1
2D	Cup Seal	1534529	OSPR3	2	15	Travers Guide (O/S Slider)	1535094	VS2017	1
2E	Ball Bearing	1534401	BGRS3-B	2	16	Internal Teeth Lock Washer	1535239	WSLCIT1	1
2F	Drag "D" Washer - Chamfered	1534867	SR3036	2	17	Spool Shaft Hex Nut	1534511	NTHX1	1
2G	Drag Disc	1534869	SR3038	4	18	Shim Washer - 0.002	1535245	SR2175	1
2H	Drag Key Washer - Octagon	1534870	SR3039	2 (3)		Shim Washer - 0.005	1535246	SR2275	1
2J	Drag "D" Washer	1534868	SR3037	1		Shim Washer - 0.010	1535247	SR2375	1
2K	Spool	1564558	VSG021-02	1	19	Drive Gear Ball Bearing	1538484	BGR02-B	1
2L	Compensation Washer		N/A	1	20	Body Cover O-Ring	1534521	ORR5	1
2M	Spool Hub	1535193	VSB2040-B	1	21	Body Cover	1564584	VSG023-04	1
2N	Clicker Sub Assembly	1538523	SR1058-1	1	22	Body Cover Ball Bearing	1534399	BGRS13	1
2P	Flat Socket Head Screw	1534543	SCFH2	1	23	Body Cup Seal	1569455	OSPR12-02	1
3	Rotor Screw	1534544	SCFH3	4	24	Timing Washer 0.5	1589945	VSB035-03	1
4	Rotor Assembly (Kit)	1613102	VSJ4009-04	1	25	Timing Washer 0.3	1589944	VSB035-02	1
4A	Line Roller Assembly	1534858	SR3020-1	1	26	Timing Washer 0.1	1589943	VSB035-01	1
4B	Line Roller Bracket	1613122	VSF007-04	1	27	Handle Assembly (Kit)	1564585	VSG318-04	1
4C	Line Roller Spindle Nut	1534862	SR3028P	1	27A	Handle Hub (Stand)	1534851	SR3014LS	1
4D	Line Roller Bracket Screw	1534539	SCBH1	3	27B	Handle Screw	1534549	SCSHC9	1
4E	Rotor	1613117	VSJ009-04	1	27C	Handle Arm	1564586	VSG018-04	1
4F	Counter Weight Screw	1535020	VR057-02	1	27D	Handle Knob Bolt Nut	1605975	SR3031-02	1
4G	Counter Weight	1582132	VSD017-01	1	27E	Handle Washer	1534753	SR2078	1
5	Spool Shaft Assembly	1605971	VS2510-1	1	27F	Handle Knob Bushing - Flanged	1534864	SR3030	1
6	Lock Ring	1564546	VSG122-01	1	27G	Power Grip Handle Knob	1596761	VS1208-03	1
7	Quad Seal	1534514	ORQ2	1	27H	Handle Knob Bushing - Plain	1534863	SR3029	1
8	Spool Shaft Guide	1564570	VSB2013-02	1	27J	Handle Knob Spindle	1605977	SR2020-02	1